

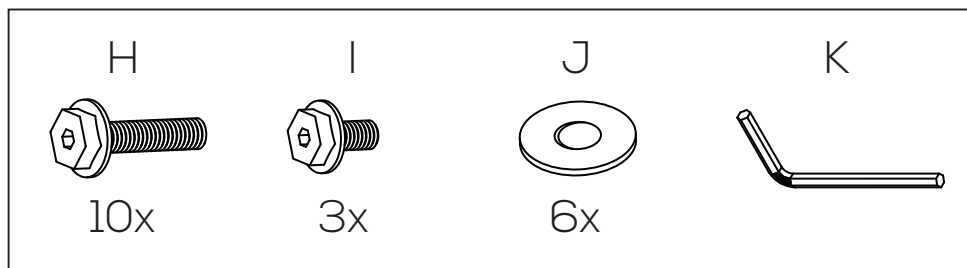

XL-300

組裝說明

組件

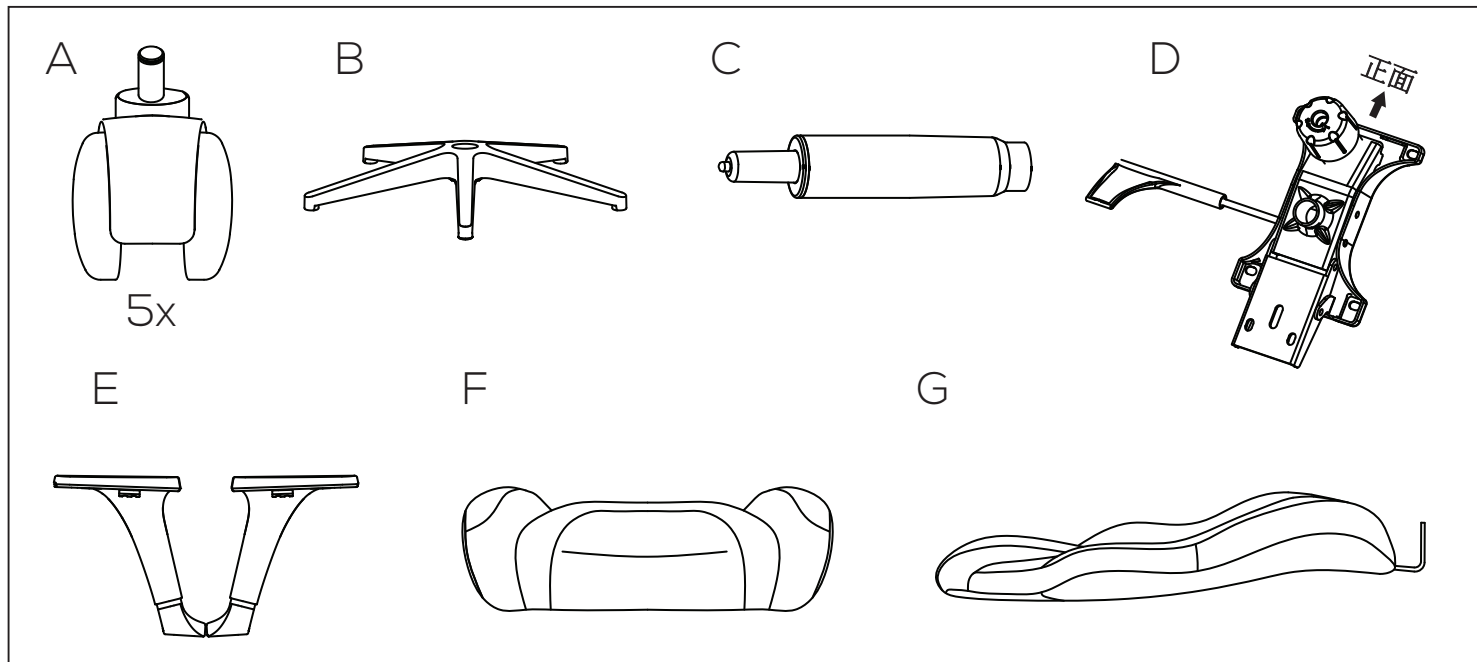

注意事項

在使用椅子之前，請確保所有螺栓和螺絲都已完全擰緊。每 6 個月或在需要時潤滑所有運動部件並擰緊所有螺栓/螺絲。

警告

為確保正確組裝，請遵循所有步驟並使用所有零件。不遵守此警告可能會導致您或他人嚴重受傷。

組裝流程

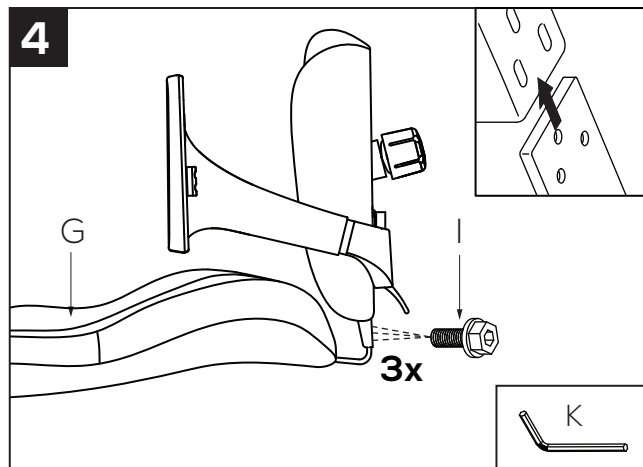
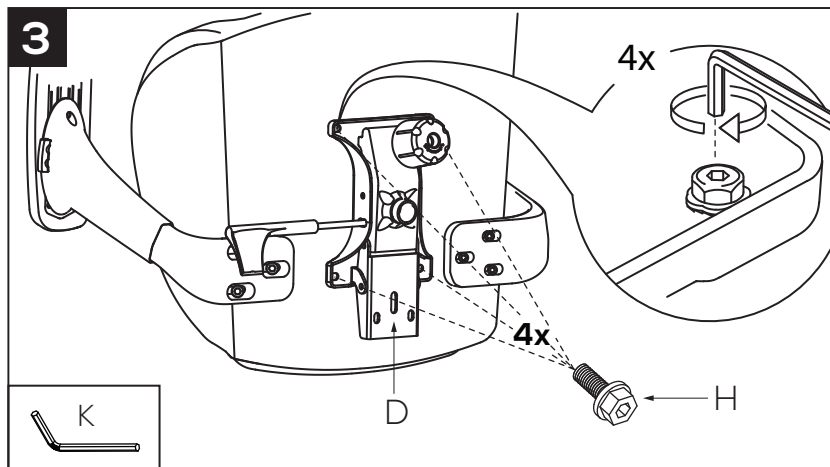
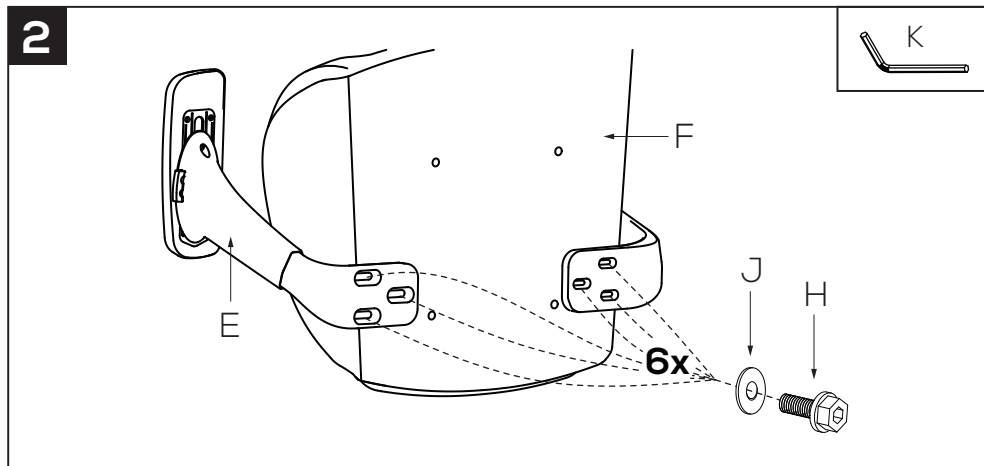
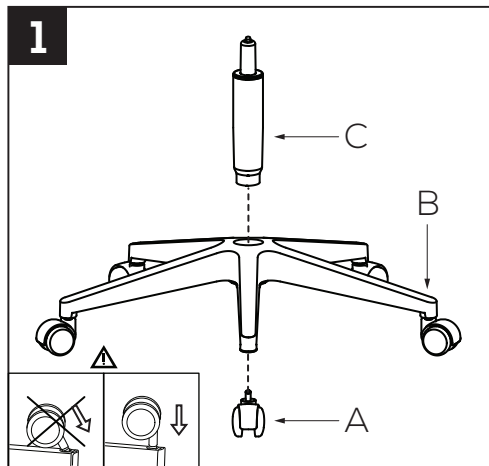

5

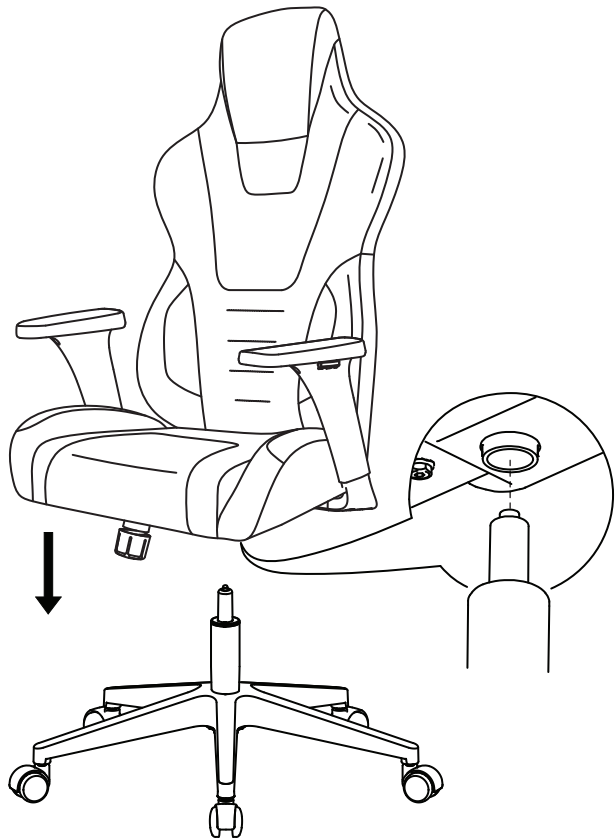

6

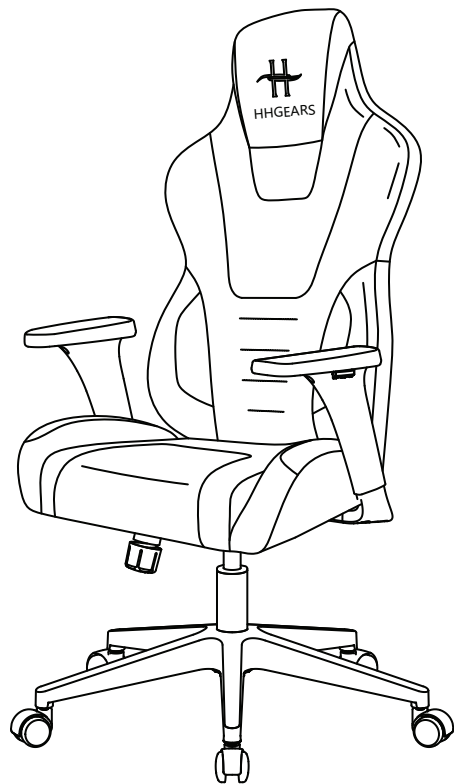

感謝您選擇HHGEARS!
www.hhgears.com

